



# OUTLET AI CONTROLLER

AC INFINITY



# WELCOME

Thank you for choosing AC Infinity. We are committed to product quality and friendly customer service. If you have any questions or suggestions, please don't hesitate to [contact](#) us. Visit [www.acinfinity.com](http://www.acinfinity.com) and click contact for our contact information.

## EMAIL

[support@acinfinity.com](mailto:support@acinfinity.com)

## WEB

[www.acinfinity.com](http://www.acinfinity.com)

## LOCATION

Los Angeles, CA

## MANUAL CODE AI2407X1

### PRODUCT

OUTLET AI  
OUTLET AI+

### MODEL

AC-ADA4  
AC-ADA8

### UPC-A

819137024410  
819137024427

# MANUAL INDEX

Manual Index .....	Page 5
Product Warning .....	Page 6
Interference from MH and HPS Lights .....	Page 7
Key Features .....	Page 8
Product Contents .....	Page 9
Powering and Setup .....	Page 10
UIS™ Platform .....	Page 12
Programming .....	Page 13
Other AC Infinity Products .....	Page 23
Warranty .....	Page 24

# PRODUCT WARNING



TO REDUCE THE RISK OF FIRE, ELECTRIC SHOCK, OR INJURY TO PERSONS, OBSERVE THE FOLLOWING:

1. Ensure your power source conforms to the electrical requirements of this product.
2. Check your local code restrictions for additional safety measures that may be needed for a proper code compliant installation.
3. Read all instructions before installing and using this product.
4. If you are unfamiliar or have doubts about performing this product's installation, seek the services of a qualified, trained, and licensed professional. Inappropriate installation will void this product's warranty.
5. Do not attempt to hardwire this product. Performing any retrofitting actions may result in personal injury and/or electrical damage, and will void this product's warranty.
6. This product must not be used in potentially hazardous locations such as flammable, explosive, chemical-laden, or wet atmospheres.
7. Do not plug in devices that will surpass what the outlet can handle (15 A).
8. Do not cover power cords with rugs or other fabric materials.
9. This product pairs with those that has rotating parts. Safety precautions should be exercised during the installation, operation, and maintenance of this product.
10. Do not insert or allow fingers or foreign objects to enter any ventilation or exhaust openings as it may cause electric shock, fire, or damage to this product. Do not block or tamper with this product in any manner while it is in operation.
11. Do not depend on the on/off programming as the sole means of shutting power from this product. Unplug the power cord before installing, servicing, or moving this product.
12. Do not operate this product while its cord is damaged, or if it malfunctions, has been dropped, or is damaged in any manner.

# INTERFERENCE from MH and HPS LIGHTS

Certain grow light models with HID\* ballasts that do not use electromagnetic shielding will create an area of radio frequency interference (RFI). This can distort nearby frequency-sensitive components like internet lines and climate sensors. RFI can be emitted from the ballast's cords or the ballast itself.

Follow these steps to ensure proper functionality and to prevent radio frequency interference from affecting your sensor probe:

## TIP 1

Keep the probe cord far away from your ballast's cords to ensure the outlet properly detects climate conditions.

You may also wrap the probe cord and create a cone around the sensor head with aluminum foil tape.

## TIP 2

Do NOT plug your grow light and inline fan into the same duplex outlet. Plug your grow light and inline fan into separate power strips and electrical sockets.

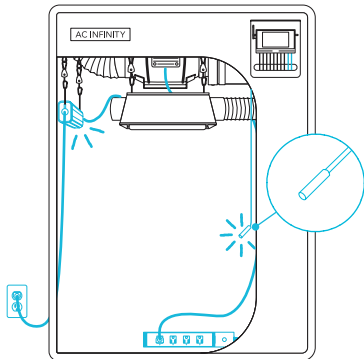

\*MH, HPS, CMH, or CHPS

# KEY FEATURES

## AI-DRIVEN

Next-generation technology powered by machine learning to automatically enhance your growing process.

## VIVID LIGHTING

Convenient LED indicators confirm whether each socket is operational and ready for smart programming.

## OVERLOAD SAFEGUARDS

Protects your devices from overloading and backs up their memory to support a smoother operating experience.

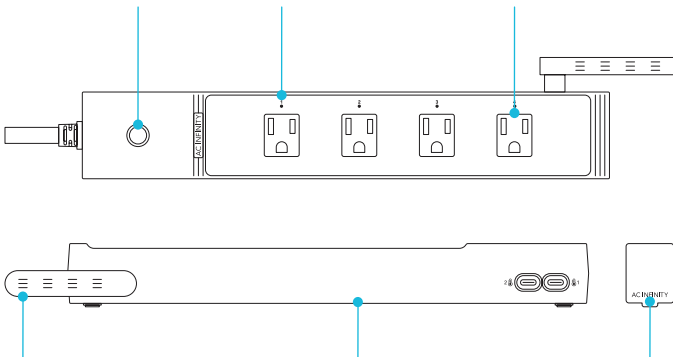

## DUAL ZONE COVERAGE

Features indoor and outdoor climate monitoring to effectively balance the environment. Additional sensors available.

## APP-CONTROLLED

Bluetooth/Wi-Fi enabled for remote access to automations, climate data, and history logs through the AC Infinity app.

## SECURE DESIGN

Includes protective seals to block out unwanted dust and moisture when the sockets are not in use.

\*Shown: Model AC-ADA4



# PRODUCT CONTENTS

## AC-ADA4



OUTLET  
CONTROLLER  
(x1)



SENSOR  
PROBE  
(x1)



WATER-  
PROOF SEAL  
(x4)



WIRE  
TIE  
(x1)



WOOD SCREWS  
(WALL HANG)  
(x2)

## AC-ADA8

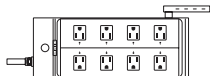

OUTLET  
CONTROLLER  
(x1)



SENSOR  
PROBE  
(x1)



WATER-  
PROOF SEAL  
(x8)

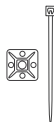

WIRE  
TIE  
(x1)



WOOD SCREWS  
(WALL HANG)  
(x2)

# POWERING AND SETUP

## STEP 1

Plug your outlet controller into an AC power outlet to power it.

Its power button and indicator lights above each socket will illuminate white to confirm it is receiving power.

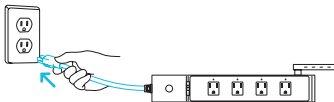

---

## STEP 2

Plug your device into a socket. Confirm that it is compatible before usage (see Product Warnings for more information).

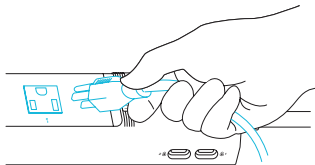

# POWERING AND SETUP

## WATER RESISTANCE

Plug waterproof seals into sockets not in use to ensure they are clear of any moisture or debris.

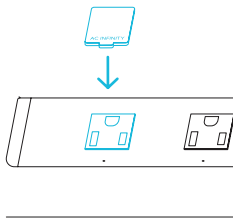

## SENSORS

Plug the sensor probe into a sensor port. Set the probe near your plants in your grow tent for the most accurate reading.

Keep the probe cord away from your HID\* grow light ballast's power cord to ensure the controller properly detects climate conditions.

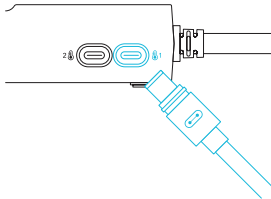

\*MH, HPS, CMH, or CHPS

# UIS™ PLATFORM

The UIS™ platform enables you to connect a single central controller with several grow devices simultaneously. By creating this fully integrated system, you can power and program all your devices together or separately for optimized grow tent management.

Your grow system can be regulated using your controller hub or remotely on the AC Infinity app (paired with compatible controllers), where you will have access to automation programming and climate data.

You can also connect your favorite grow light and outlet device to integrate them into the UIS platform using our RJ11/12 adapter and control plug module.

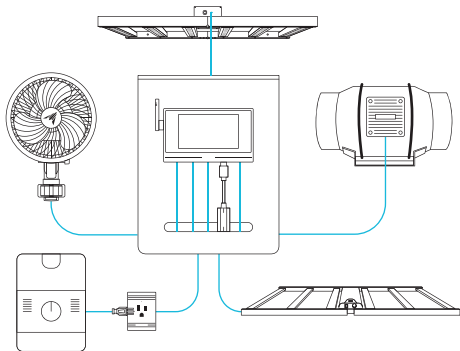

**Grow devices will be sold separately and may still be in development at the time of your purchase of this product.**

# PROGRAMMING

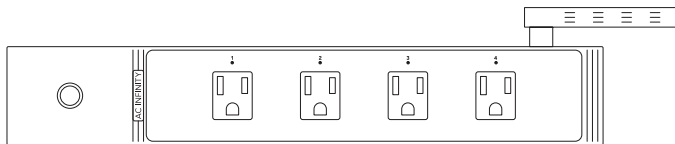

## ON/OFF

Press the power button to turn your outlet controller ON or OFF.

---

## FACTORY RESET

Factory reset your outlet controller by holding the power button for 15 seconds. Its lights will flash twice and remain lit after power delivery is restored.

# PROGRAMMING

## DOWNLOAD THE APP

### THE AC INFINITY APP

The AC Infinity app enables you to connect with the next generation of our intelligent controllers, giving you access to advance programs and environmental data\*.

1

Download the AC Infinity app from the App Store or Play Store by searching “AC Infinity”.



2

Open the AC Infinity app and follow the instructions in the next section to pair your outlet controller with the app.



### HOW TO USE THE APP

Visit our website at [www.acinfinity.com](http://www.acinfinity.com) or open your smartphone camera and scan the QR code below for more information on the AC Infinity app.

\*Appearance and features subject to change.

# PROGRAMMING

## CONNECT VIA BLUETOOTH

### SETUP AND PAIRING

Power your outlet controller on before pairing it with the app. Logging in or creating an account beforehand will expedite the pairing process. Have your Wi-Fi network's name and password ready.

1

Tap on the "+" tab to add your smart device.

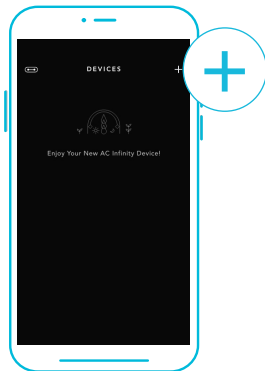

2

Select "Smart Outlets".

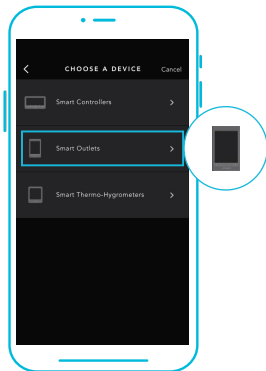

Wi-Fi and location permissions must be enabled on your mobile device before starting the pairing process.

# PROGRAMMING

## CONNECT VIA BLUETOOTH

3

Select "OUTLET AI" or "OUTLET AI+."

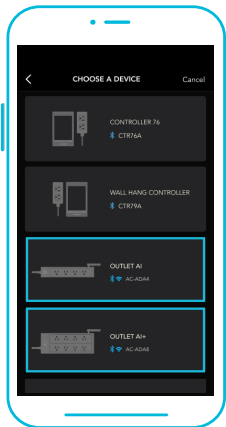

4

Hold the power button for 5 seconds to activate Bluetooth Pairing Mode. Release the button and the light will start flashing green to indicate it's ready for pairing.

The power button light will start flashing green and white until the pairing is completed. When paired successfully, the power button light will remain green.

Hold the power button for 5 seconds again to stop the pairing process. Your outlet controller will automatically stop the pairing process if no connection to the app is established after 5 minutes.

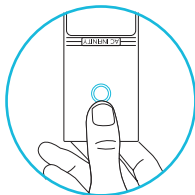



# PROGRAMMING

## CONNECT VIA BLUETOOTH

5

Tap "BLUETOOTH ONLY" to begin pairing. To connect using Wi-Fi, skip to step 8.



6

Connecting with Bluetooth will disable Wi-Fi functionality. Go to the app settings page to re-enable and connect using Wi-Fi.

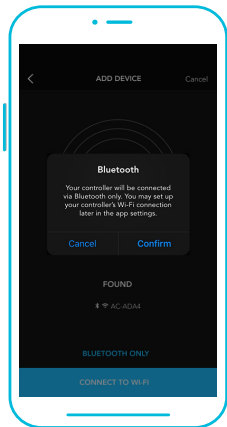

When pairing the app around multiple devices, move your mobile device closer to your outlet.

# PROGRAMMING

## CONNECT VIA BLUETOOTH

7

Tap the DONE button to complete the pairing process.

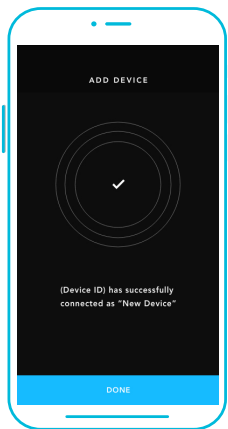

# PROGRAMMING

## CONNECT VIA WI-FI

8

Log in or create an account to continue.

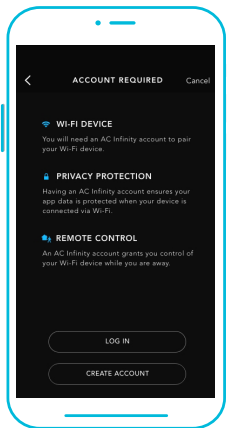

9

Enter your Wi-Fi network's password. You may also connect to an alternate 2.4 GHz router\*.

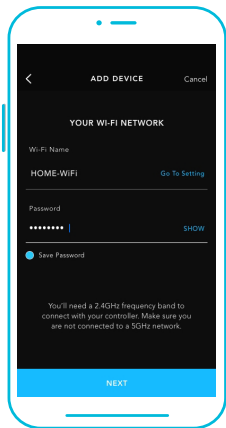

When pairing the app around multiple controllers, move your mobile device closer to your desired controller.

# PROGRAMMING

## CONNECT VIA WI-FI

10

Follow these tips if the pairing process is unsuccessful.

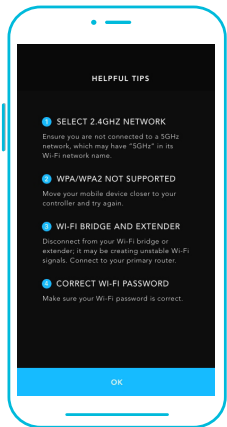

11

Tap the DONE button to complete the pairing process.

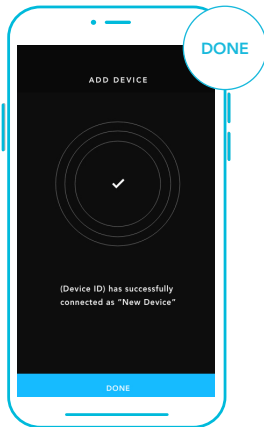

\*This controller is only compatible with 2.4 GHz frequency band routers. When connecting using Wi-Fi, make sure your mobile device is not connected to a 5 GHz frequency band network.

# PROGRAMMING

## CONNECT VIA WI-FI

12

Your outlet controller will appear in your smart device with a unique ID.

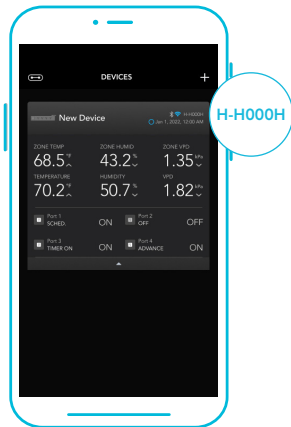

# PROGRAMMING

## OVERLOAD PROTECTION

### WHAT TO EXPECT

When your outlet controller's total current reaches or exceeds 15 A, an overload will occur. Its power button will illuminate red as it continuously buzzes. At this point, all sockets and their indicators will power off as your app receives an alert and app control is disabled.

Press the power button to reset your outlet controller.

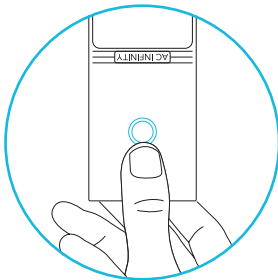

# AC INFINITY PRODUCTS

## Advance Grow Tents

The CLOUDLAB series is a line of grow tents designed to create ideal growing conditions and facilitate indoor plant cultivation year-round. Features 2000D thick oxford canvas lined with inner diamond patterned mylar that maximizes grow light luminosity, and a reinforced frame with 150 lb. weight capacity. Includes a mounting plate to install your AC Infinity controller onto.

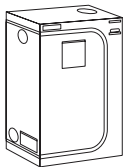

---

## Water Pump

A submersible pump designed to circulate and deliver water to plant roots for enhanced yields in hydroponic settings. Featuring a high-performance motor and interchangeable nozzles, this water pump is capable of quietly and efficiently enhancing water flow for multiple irrigation systems.



---

## Seedling Mats

The SUNCORE series is a line of seedling mats designed to improve germination success rate by emitting a warming heat base. Utilizes even heating far-infrared film enveloped in flexible quad-layered PVC with IP-67 water-resistant rating. Features a knob controller that adjusts heat levels to meet unique seedling needs.



Discover the latest innovations in environmental controls at [acinfinity.com](http://acinfinity.com)

# WARRANTY

This warranty program is our commitment to you, the product sold by AC Infinity will be free from defects in manufacturing for a period of two years from the date of purchase. Commercial grow lights sold by AC Infinity receive a five year warranty period. If a product is found to have a defect in material or workmanship, we will take the appropriate actions defined in this warranty to resolve any issues.

The warranty program applies to any order, purchase, receipt, or use of any products sold by AC Infinity or our authorized dealerships. The program covers products that have become defective, malfunctioned, or expressively if the product becomes unusable. The warranty program goes into effect on the date of purchase. The program will expire two years from the date of purchase (five years from the date of purchase of commercial grow lights). If your product becomes defective during that period, AC Infinity will replace your product with a new one or issue you a full refund.

The warranty program does not cover abuse or misuse. This includes physical damage, submersion of the product in water, incorrect installation such as wrong voltage input, and misuse for any reason other than intended purposes. AC Infinity is not responsible for consequential loss or incidental damages of any nature caused by the product. We will not warrant damage from normal wear such as scratches and dings.

Contact our dealers department at [dealers@acinfinity.com](mailto:dealers@acinfinity.com) or (626) 838-4656 for more information about our dealers and distributors program. Contact our customer service department at [support@acinfinity.com](mailto:support@acinfinity.com) or (626) 923-6399 for product and warranty assistance. Our business hours are Monday through Friday, 9:00 am to 5:00 pm PST.



**If you have any issues with this product, contact us and we'll happily resolve your problem or issue a full refund!**



**COPYRIGHT © 2024 AC INFINITY INC. ALL RIGHTS RESERVED**

No part of the materials including graphics or logos available in this booklet may be copied, photocopied, reproduced, translated or reduced to any electronic medium or machine readable form, in whole or in part, without specific permission from AC Infinity Inc.





[www.acinfinity.com](http://www.acinfinity.com)